



Incremental encoder

- ▶ Only 30 mm diameter
- ▶ 3 short-circuit protected outputs 1, 2, 0
- ▶ Status output for warning indication
- ▶ Shock and vibration protected
- ▶ IP 65 at housing, IP 54 at shaft inlet
- ▶ 5 Vdc or 9...30 Vdc



320

ELECTRICAL SPECIFICATION

Supply voltage +EV	9-30V	5V ±10%
	Polarity protected	---
Current consumption at no load	35mA @ 24V Max 110mA	70mA Max 150mA
Line counts	10, 20, 25, 30, 50, 60, 80, 100, 160, Other Line counts on request	
Measuring steps	Max 4 x Line counts	
Accuracy		
Dividing error	± 50° el	
Channel separation	90° ± 25° el	
Outputs	HTL	TTL
	Short circuit protected	
Load max	± 20mA	
Max cable length	100m @ 50kHz	
U _{high} (at 10mA load)	> +EV - 3,0V	> 3,0V
U _{low} (at 10mA load)	< 0,5V	< 0,4V
Frequency range	0...200kHz	
STATUS signal		
Encoder OK	High level	
Warning / Failure	Low level	min 25ms

ACCESSORIES

Coupling 4-4 mm	Part. No. 00202019
Measuring wheel, 200 mm	See sheet for accessories

OUTPUT CIRCUIT

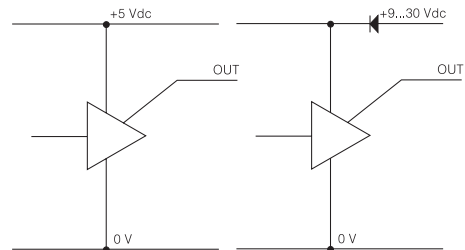

OUTPUT SIGNALS

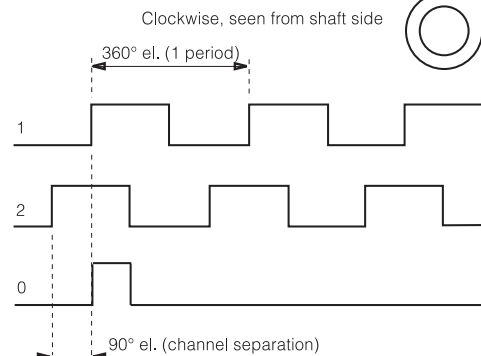

STATUS = Warning

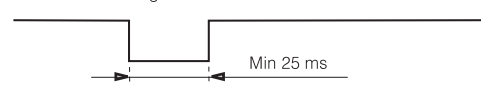

CONNECTION

Function	Colour
1	Green
2	Yellow
0	Brown
+ E Volt	Red
0 Volt	Blue
STATUS	Grey
Case	Shield

320

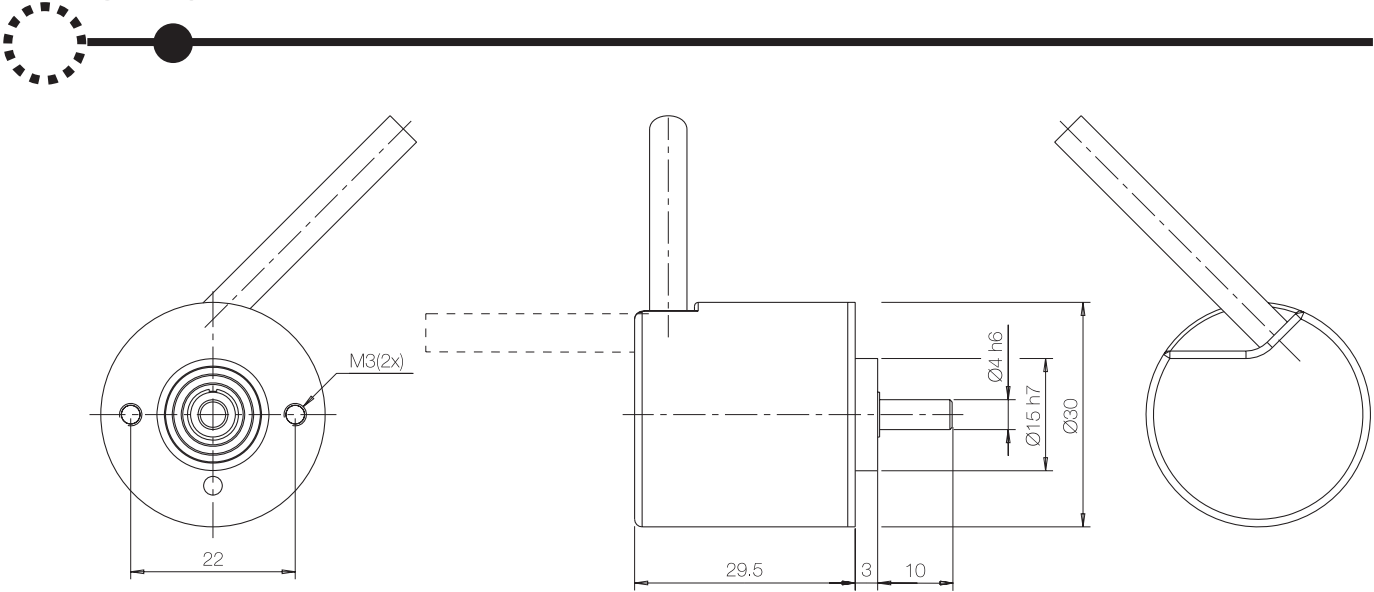

MECHANICAL SPECIFICATION

Shaft, Stainless steel	Ø4mm
Moment of inertia	0,15 x 10 ⁻⁶ kgm ²
Load max	
Radial	10N
Axial	10N
Speed max	3000 rpm (12000 rpm)
Code disc	Standard
Temperature	
Operating	-25°C ... +70°C
Storage	-25°C ... +70°C
Housing	Aluminum
Weight	Approx. 70 g
Protection class	IP 65 according to IEC 529
Shaft inlet	IP 54 according to IEC 529
Vibration	<100m/s ² (50...2000 Hz)
Shock	<1000m/s ² (11ms)
Cable	6x0,25mm ² PVC

ORDERING INFORMATION

3 2 0 - [] [] [] [] [] [] [] [] - [] [] [] [] [] [] [] []

Option

00 = Standard

Shaft

8 = Ø 4 mm

Connection

3 = Cable, 1.5 m

9 = Cable, xx m

Supply voltage

1 = 5 Vdc

5 = 9...30 Vdc

Internal use

1 = 10, 20, 25, 30, 80, 100, 125, 500, 512, 600, 625 ppr

5 = 50, 60, 160, 200, 250, 1000, 1024, 1200, 1250 ppr

Line counts

Leine&Linde ISO 9001 / ISO 14001 certified

Leine&Linde AB, Box 8, SE-645 21 Strängnäs, Sweden. Olivehällsvägen 8.
Phone: +46 (0)152 265 00. Fax: +46 (0)152 265 05. E-mail: info@leinelinde.se

05-03-09 PS. Specifications can be changed without prior notice.

www.leinelinde.se